

# SENSORS WITH CONNECTION HEADS

## Configuration Code GP03 Spring-Loaded RTD/Thermowell Assemblies with General-Purpose Connection Heads

Spring-Loaded RTD/Thermowell Assemblies with General-Purpose Connection Heads are designed for use with various thermowell types. Complete assemblies can be ordered by selecting the RTD assembly below, the thermowell from the thermowell section of this catalog, and a temperature transmitter from the back of this section. Assemblies without a thermowell can be ordered by selecting the sensor assembly from this page and inserting the "S" length in table 2-0. These sensors are supplied with a 316 stainless steel sheath and are available in various tolerances and temperature ranges as noted in the tables below. **Note:** The "S" dimension will measure 1/4" longer than specified when the spring is in the relaxed position. The "S" dimension is calculated when the sensor is compressed or in the installed position. This design allows 1/4" spring compression to ensure positive contact with the bottom of the thermowell.

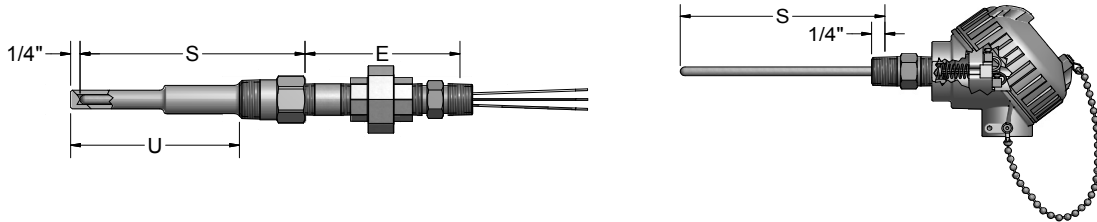

### ORDER CODES

**Example Order Number:** **R1T185L** **48** **3** - Select Thermowell Part # or Insert 3 Digit Length Code - **SL** - **8HN** **31**, **T** - Select Type and Range from back of section

#### 1-0 100 Ω Platinum RTD Elements $\alpha = 0.00385 \text{ } ^\circ\text{C}^{-1}$

CODE		TOLERANCE <sup>[1]</sup>
LOW RANGE WIRE WOUND (-200 to 200) °C		
<b>SINGLE</b>	<b>DUPLEX</b>	
R1T185L	R1T285L	Grade B
R5T185L	R5T285L	(1/5) Class B
LOW RANGE THIN FILM (-50 to 200) °C		
RBF185L	RBF285L	Class B
RAF185L	RAF285L	Class A
HIGH RANGE WIRE WOUND (-200 to 600) °C		
R1T185H	R1T285H	Grade B
RAT185H	RAT285H	Class A

[1] Refer to RTD tolerance information in the General Information section for calculations to determine specific tolerance at temperature.

#### 1-1 Sheath Diameters

CODE	DIAMETERS (inches) 316 SS
38	3/16
48	1/4

#### 1-2 Element Connection

CODE	DESCRIPTION
2	2-wire element
3	3-wire element
4 <sup>[1]</sup>	4-wire element

[1] Not available in duplex or with 440 Series Transmitter

#### 3-0 Element Options

CODE	DESCRIPTION
SL <sup>[1]</sup>	Spring-loaded element
SC	Self-contained spring-loaded element
SN	Self-contained spring-loaded element with Buna-N oil seal 121°C [250°F] 100 PSI Max.

[1] Not available with option 35T-642A

**2-0**  
Select thermowell part number from Thermowell Section, or specify 3 digit "S" length in inches if no thermowell is required.

#### 4-0 Head Mounting Fittings

CODE	DESCRIPTION	CODE	DESCRIPTION
STEEL FITTINGS		316SS FITTINGS	
6HN	1/2" x 1/2" NPT hex nipple 1" length	8HN	1/2" x 1/2" NPT hex nipple 1" length
6PN <sub>-</sub>	1/2" NPT pipe nipple (specify "E" length in inches)	8PN <sub>-</sub>	1/2" NPT pipe nipple (specify "E" length in inches)
6PU <sub>-</sub> <sup>[1]</sup>	1/2" NPT union/nipple (specify "E" length in inches)	8PU <sub>-</sub> <sup>[1]</sup>	1/2" NPT union/nipple (specify "E" length in inches)

[1] 4" Minimum length required

#### 4-1 Head and Sheath Terminations

CODE	DESCRIPTION
22	3" Individual fluoropolymer leads with terminal pins
31	Aluminum screw-cover head
34	Cast iron screw-cover head
35T-642A	(4 to 20) mA HART® Field Transmitter with aluminum general-purpose housing
36T82-D10	(4 to 20) mA dual input HART® transmitter with digital display and general-purpose aluminum housing with glass lid
49	Flip-top aluminum head
63	White polypropylene screw-cover head
91	316 L stainless steel screw-cover head

#### 4-2 Options

W <sup>[1]</sup>	Epoxy Coating
GS	Ground screw
I	Stainless tag
NB	1/2" NPT nylon conduit reducer bushing
SB	1/2" NPT conduit reducer bushing
T-440	(4 to 20) mA head-mounted RTD transmitter
T-441	(4 to 20) mA isolated head-mounted transmitter
T-442	(4 to 20) mA isolated HART® head-mounted transmitter
T82-00	(4 to 20) mA dual input HART® head-mounted transmitter

See transmitter ordering information in back of section.

[1] Available with option 31 only.

HART® is a registered trademark of HART Communication Foundation.



# SENSORS WITH CONNECTION HEADS

## Configuration Code GP03 Spring-Loaded RTD/Thermowell Assemblies with Explosion-Proof Connection Heads

Spring-Loaded RTD/Thermowell Assemblies with Explosion-Proof Connection Heads are designed for use with various thermowell types. Complete assemblies can be ordered by selecting the RTD assembly below, the thermowell from the thermowell section of this catalog, and a temperature transmitter from the back of this section. Assemblies without a thermowell can be ordered by selecting the sensor assembly from this page and inserting the "S" length in table 2-0. These sensors are supplied with a 316 stainless steel sheath and are available in various tolerances and temperature ranges as noted in the tables below. **Note:** The "S" dimension will measure 1/4" longer than specified when the spring is in the relaxed position. The "S" dimension is calculated when the sensor is compressed or in the installed position. This design allows 1/4" spring compression to ensure positive contact with the bottom of the thermowell.

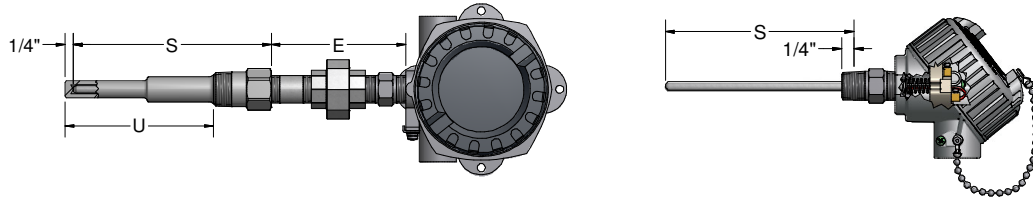

### ORDER CODES

**Example Order Number:** **RBF185L** **48** **3** - Select Thermowell Part # or Insert 3 Digit Length Code - **SL** - **8HN 93, T-** Select Type and Range from back of section

#### 1-0 100 Ω Platinum RTD Elements $\alpha = 0.00385 \text{ } ^\circ\text{C}^{-1}$

CODE		TOLERANCE <sup>[1]</sup>
LOW RANGE WIRE WOUND (-200 to 200) °C		
<b>SINGLE</b>	<b>DUPLEX</b>	
R1T185L	R1T285L	Grade B
R5T185L	R5T285L	(1/5) Class B
LOW RANGE THIN FILM (-50 to 200) °C		
RBF185L	RBF285L	Class B
RAF185L	RAF285L	Class A
HIGH RANGE WIRE WOUND (-200 to 600) °C		
R1T185H	R1T285H	Grade B
RAT185H	RAT285H	Class A

[1] Refer to RTD tolerance information in the General Information section for calculations to determine specific tolerance at temperature.

#### 1-1 Sheath Diameters

CODE	DIAMETERS (inches) 316 SS
38	3/16
48	1/4

#### 1-2 Element Connection

CODE	DESCRIPTION
2	2-wire element
3	3-wire element
4 <sup>[1]</sup>	4-wire element

[1] Not available in duplex or with 440 Series Transmitter

#### 2-0

Select thermowell part number from Thermowell Section, or specify 3 digit "S" length in inches if no thermowell is required.

#### 4-1 Head Terminations

CODE	DESCRIPTION
74	DIN form B aluminum explosion-proof head, Group A
75T-642C	(4 to 20) mA HART® field transmitter with aluminum explosion-proof housing, Group A
93	Aluminum explosion-proof head, Group B
94	316L stainless steel explosion-proof head, Group A

#### 4-2 Options

SB	1/2" NPT conduit reducer bushing
I	Stainless tag
T-440 <sup>[1]</sup>	(4 to 20) mA head-mounted RTD transmitter
T-441	(4 to 20) mA isolated head-mounted transmitter
T-442	(4 to 20) mA isolated HART® head-mounted transmitter
T82-00	(4 to 20) mA dual input, isolated HART® head-mounted transmitter

**See transmitter ordering information in back of section.**  
[1] Not available with option 74.

#### 4-0 Head Mounting Fittings

CODE	DESCRIPTION	CODE	DESCRIPTION
<b>STEEL FITTINGS</b>		<b>316SS FITTINGS</b>	
6HN	1/2" x 1/2" NPT hex nipple 1" length	8HN	1/2" x 1/2" NPT hex nipple 1" length
6PN <sub>-</sub>	1/2" NPT pipe nipple (specify "E" length in inches)	8PN <sub>-</sub>	1/2" NPT pipe nipple (specify "E" length in inches)
6XU <sub>-</sub> <sup>[1]</sup>	1/2" NPT union/nipple (specify "E" length in inches)	8XU <sub>-</sub> <sup>[1]</sup>	1/2" NPT union/nipple (specify "E" length in inches)

[1] 3 1/2" Minimum length required

#### 3-0 Element Options

CODE	DESCRIPTION
SL	Spring-loaded element
SC	Self-contained spring-loaded element
SN	Self-contained spring-loaded element with Buna-N oil seal 121°C [250°F] 100 PSI Max.

HART® is a registered trademark of HART Communication Foundation.

The drilled thermowells listed below are those most commonly found in process applications. Other types and styles are listed later in this section. The thermowells listed below are available as separate component wells and can be ordered by the code numbers listed below. They can also be ordered as a part of a complete sensor assembly. Consult factory for wells with different mounting threads, lengths, and materials.

### STANDARD-DUTY WELLS

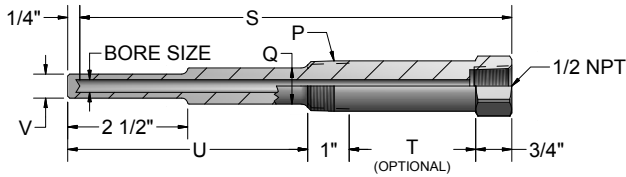

### STRAIGHT-SHANK, SOCKET-WELD

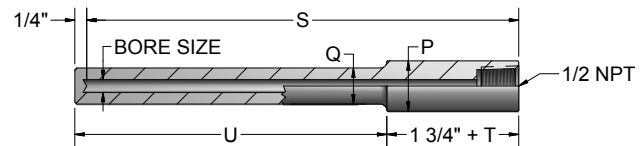

### HEAVY-DUTY WELLS

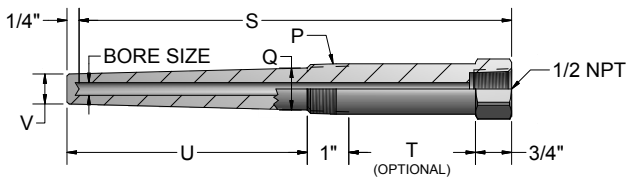

### WELD-IN WELLS

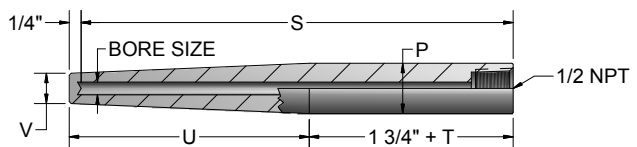

## ORDER CODES

### Example Order Number:

1-0 1-1 1-2 1-3 1-4 1-5 1-6  
**S 4 D 06 08 T2 S**

#### 1-0 Well Type

CODE	DESCRIPTION
S	Standard-duty threaded (NPT)
H	Heavy-duty threaded (NPT)
SW	Straight-shank, socket-weld
WI	Weld-in

#### 1-1 Bore Size

CODE	DESCRIPTION
4	0.260 Dia. Bore

#### 1-2 Pipe Size "P"

CODE	DESCRIPTION
C	1/2" Pipe <sup>[1]</sup>
D	3/4" Pipe
E	1" Pipe

[1] Only available with well type S or H

#### 1-3 Length Dimensions (inches)

CODE	"S" DIMENSIONS	"U" DIMENSIONS	
		NO LAG	WITH STANDARD LAG
04	4	2(1/2)	N/A
06	6	4(1/2)	2(1/2)
09	9	7(1/2)	4(1/2)
12	12	10(1/2)	7(1/2)
15	15	13(1/2)	10(1/2)
18	18	16(1/2)	13(1/2)
24	24	22(1/2)	19(1/2)

#### 1-6 Well Options

CODE	DESCRIPTION
C8	316 stainless steel well cap and chain
C22	Brass well cap and chain
S	Customer specified part number marked on the thermowell - (10 digit maximum)

#### 1-5 Optional "T" Lag Dimension

CODE	DESCRIPTION
Leave blank if No Lag is required	
T2	2" Lag standard on 6" well
T3	3" Lag standard on 9, 12, 15, 18, 24" wells
T__	Special Lag specify "T" dimension in inches

#### 1-4 Material

CODE	DESCRIPTION
8	316 stainless steel
9	304 stainless steel

The flanged thermowells described on this page are those commonly found in most process applications. These wells are supplied as standard- or heavy-duty with raised-faced flanges. Other types and styles are listed later in this section. Consult factory for wells with different flange sides, lengths, and materials.

## FLANGED THERMOWELLS

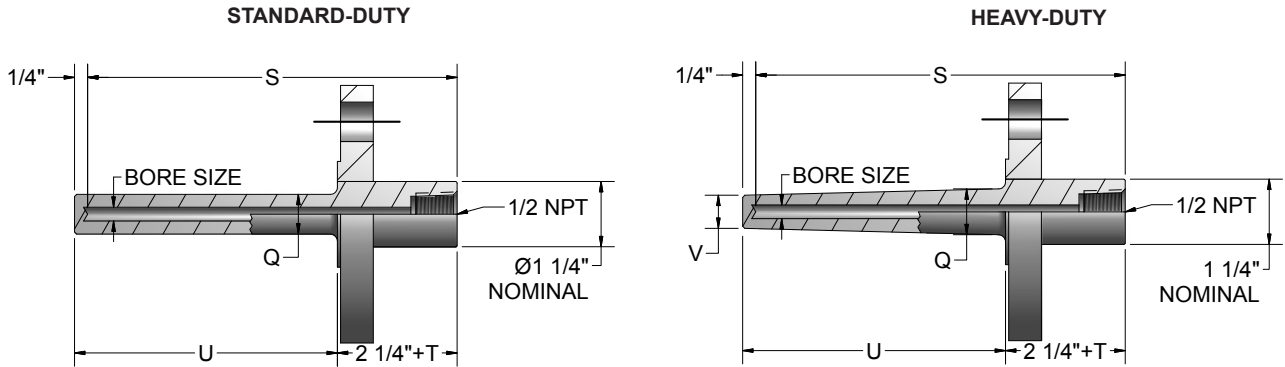

## ORDER CODES

**Example Order Number:**

1-0 1-1 1-2 1-3 1-4 1-5 1-6 1-7 1-8  
**SF 4 15 R 3 12 08 T2 C8**

### 1-0 Well Type

CODE	DESCRIPTION
SF	Standard-duty flanged
HF	Heavy-duty flanged

### 1-1 Bore Size

CODE	DESCRIPTION
4	0.260 Bore

### 1-2 Flange Size

CODE	DESCRIPTION
10	1"
15	1 1/2"
20	2"

### 1-3 Flange Type

CODE	DESCRIPTION
R	Raised face

### 1-4 Pressure Rating

CODE	DESCRIPTION
1	150 class
3	300 class

### 1-8 Well Options

CODE	DESCRIPTION
C8	316 stainless steel well cap and chain
C22	Brass well cap and chain
S	Customer specified part number marked on thermowell (10 digit maximum)

### 1-7 Optional "T" Lag Dimension

CODE	DESCRIPTION
	Leave blank if no lag is required
T__	Specify "T" dimension in inches

### 1-6 Well Material

CODE	DESCRIPTION
08	316 Stainless steel
09	304 Stainless steel

### 1-5 Well Length (inches)

CODE	DESCRIPTION	
	"S" DIMENSION	"U" DIMENSION
06	6	4
09	9	7
12	12	10
15	15	13
18	18	16
24	24	22